

Space Plans

AURORA

Corporate Setting

1:8 with 30% Agile
224 Desks = 160 + 64 Agile

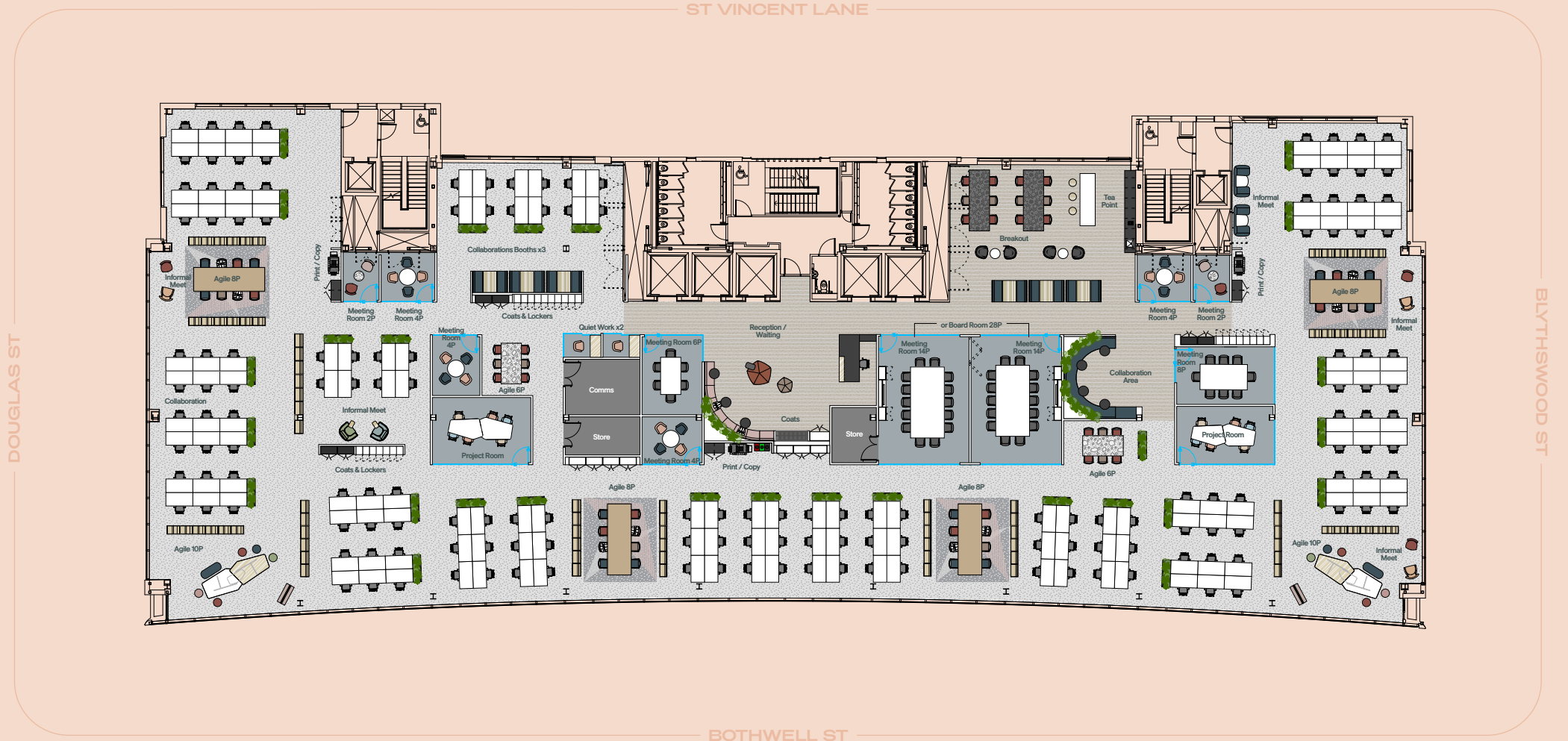

Agile Setting

1:10 with 25% Agile
224 Desks = 140 + 48 Agile

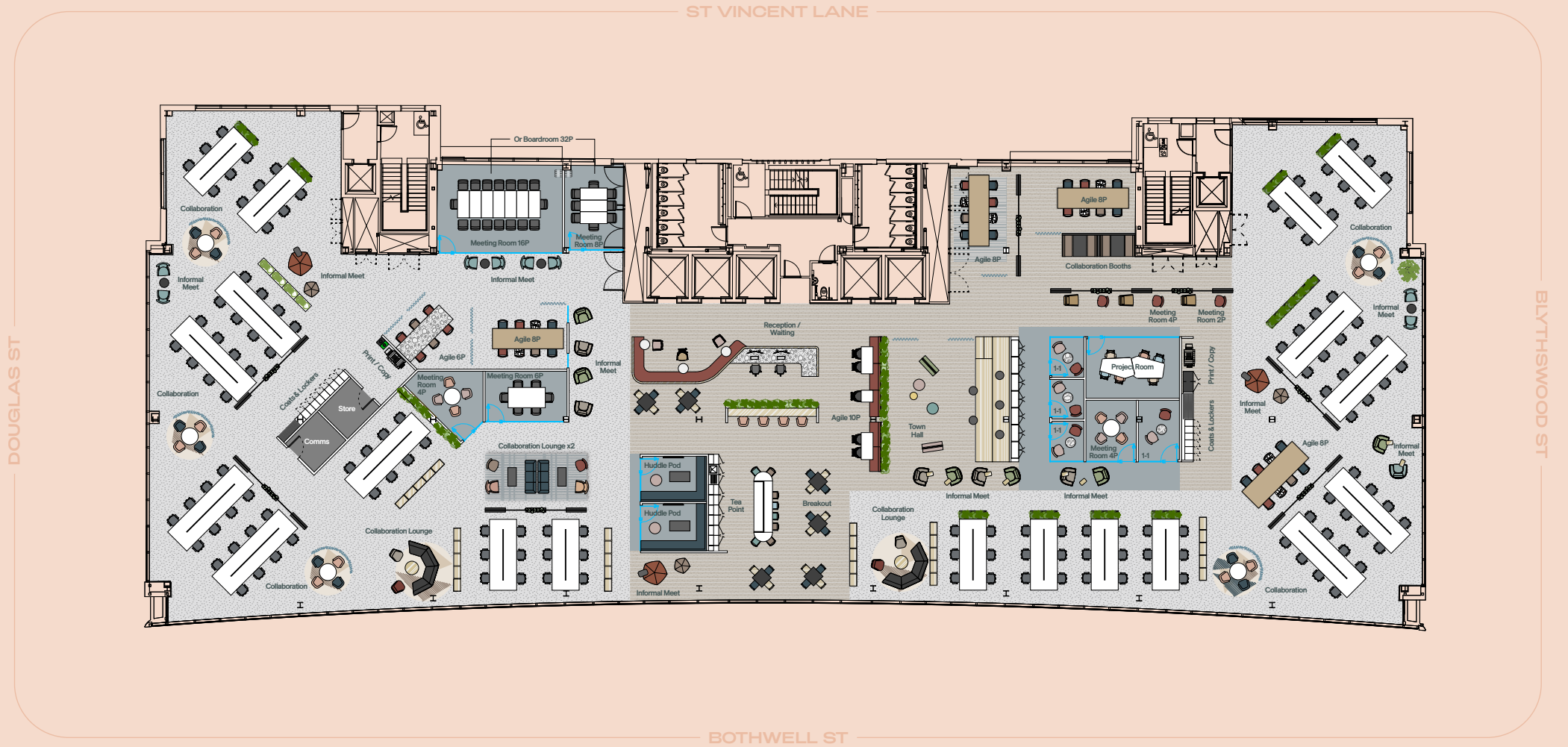

Split Floor: Corporate Setting

1:8 with 10% Agile
92 Desks = 82 + 10 Agile

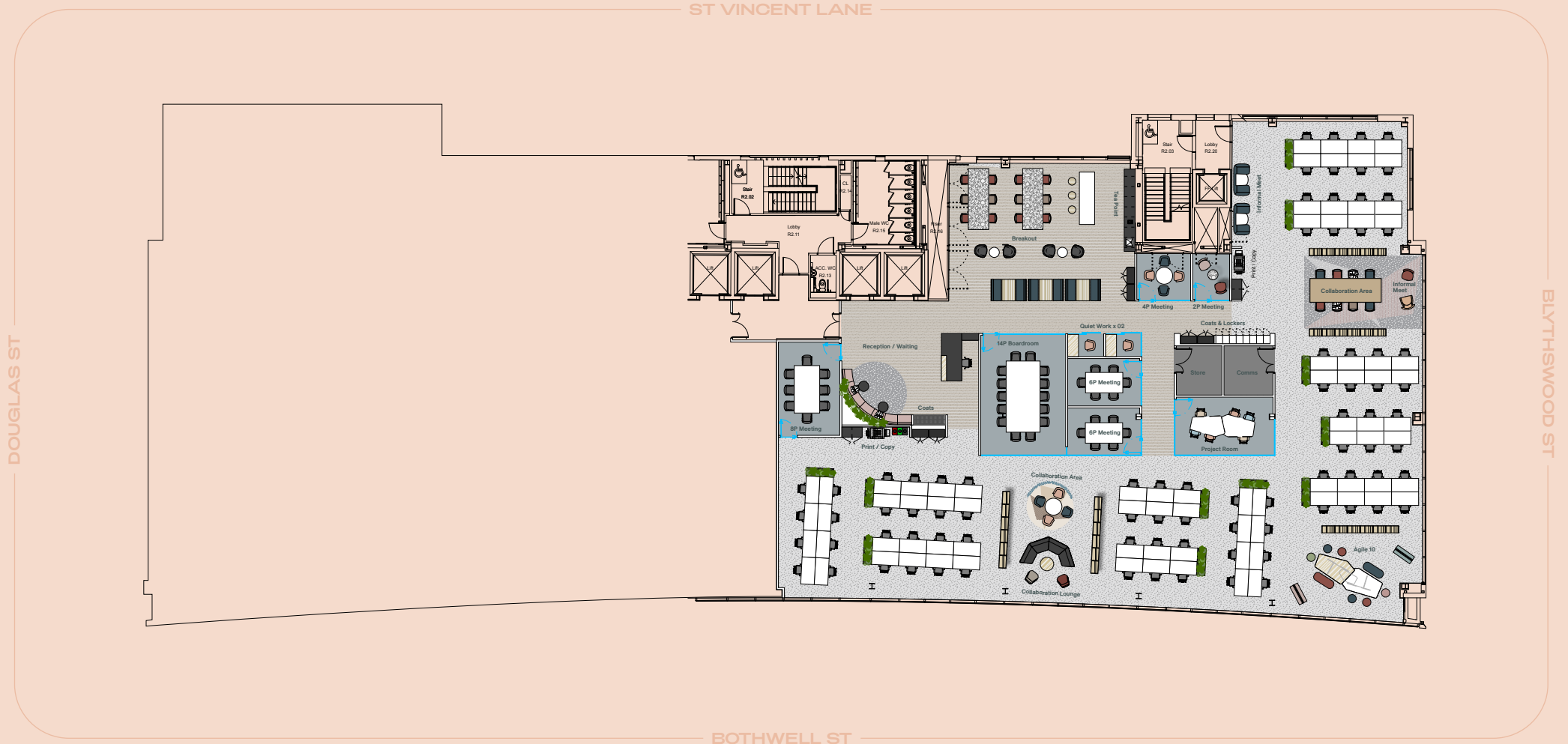

1st Floor

1:8 with 40% Agile
66 Desks = 40 + 26 Agile

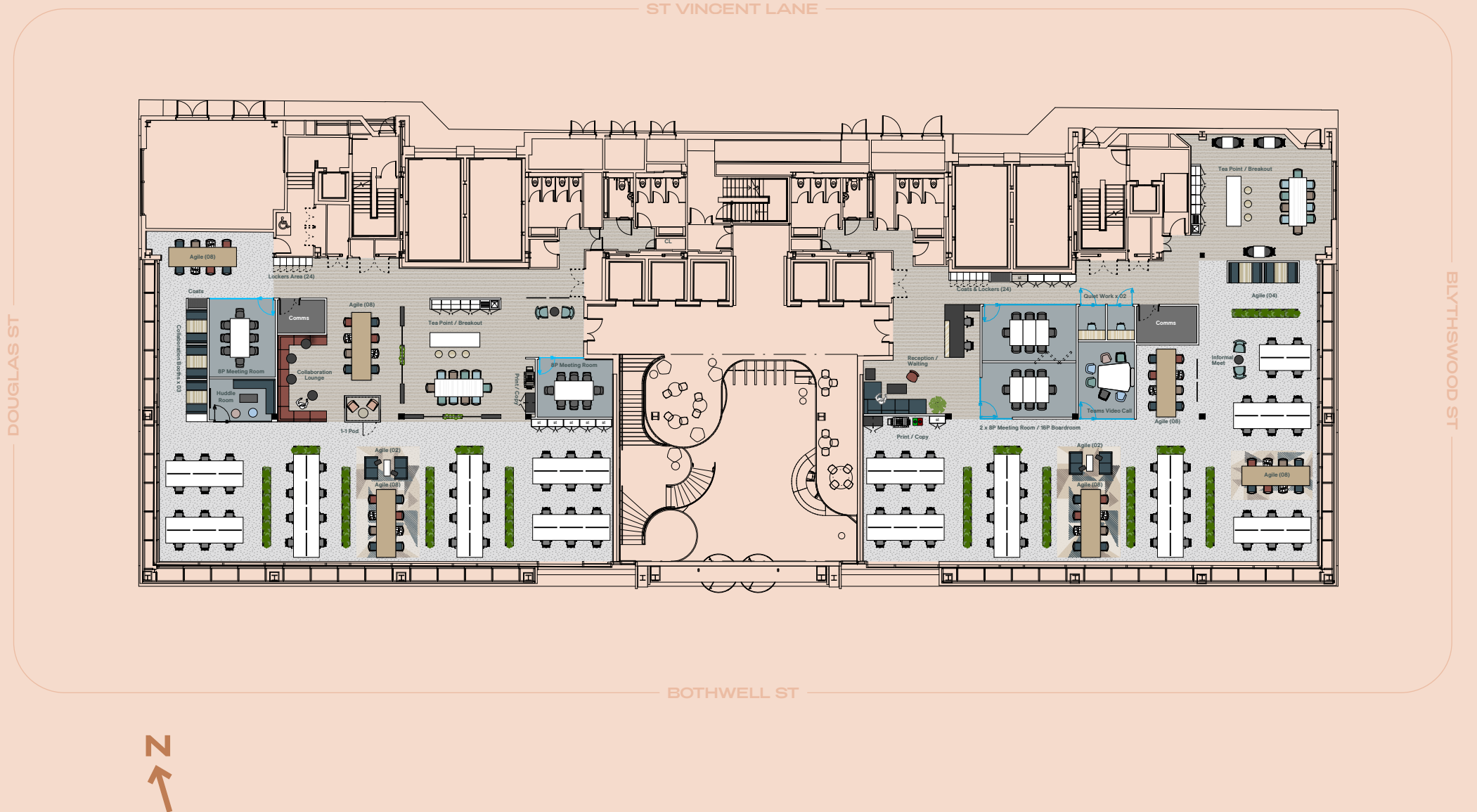

Typical Floor: Split Option

1:8 with 40% Agile
134 Desks = 80 + 54 Agile

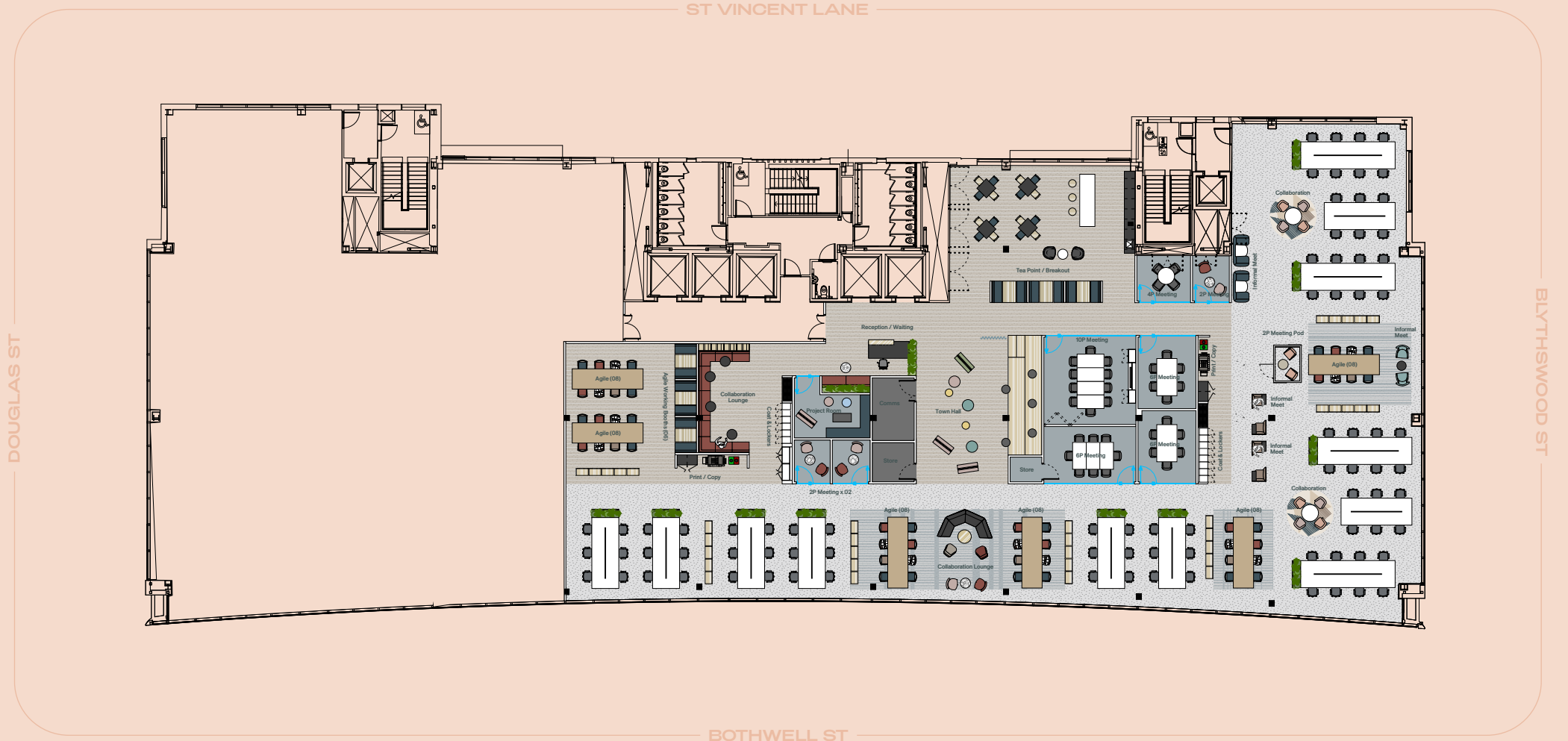

Corporate Setting

1:10 with 25% Agile
180 Desks = 135 + 45 Agile

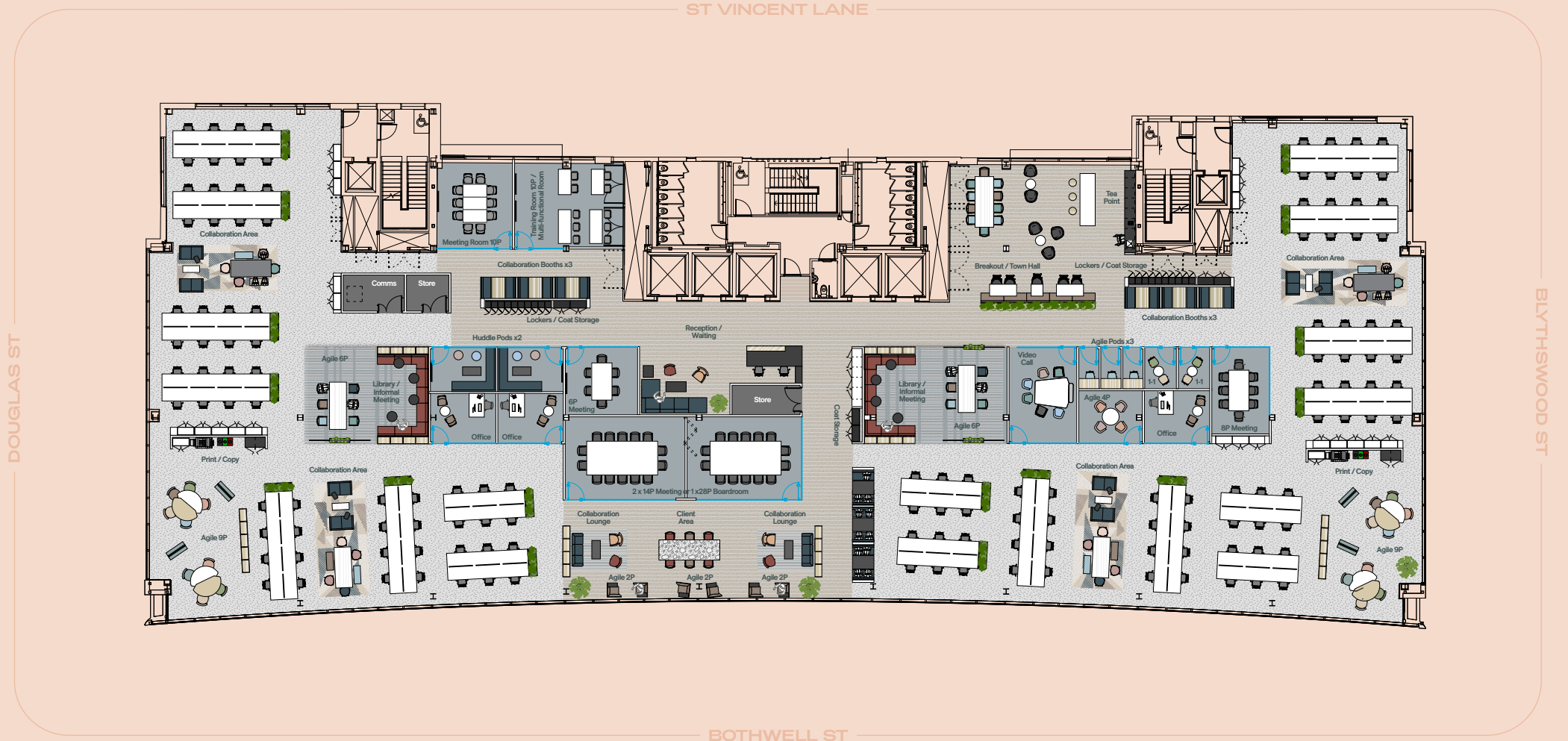

Agile Setting

1:10 with 25% Agile
180 Desks = 132 + 48 Agile

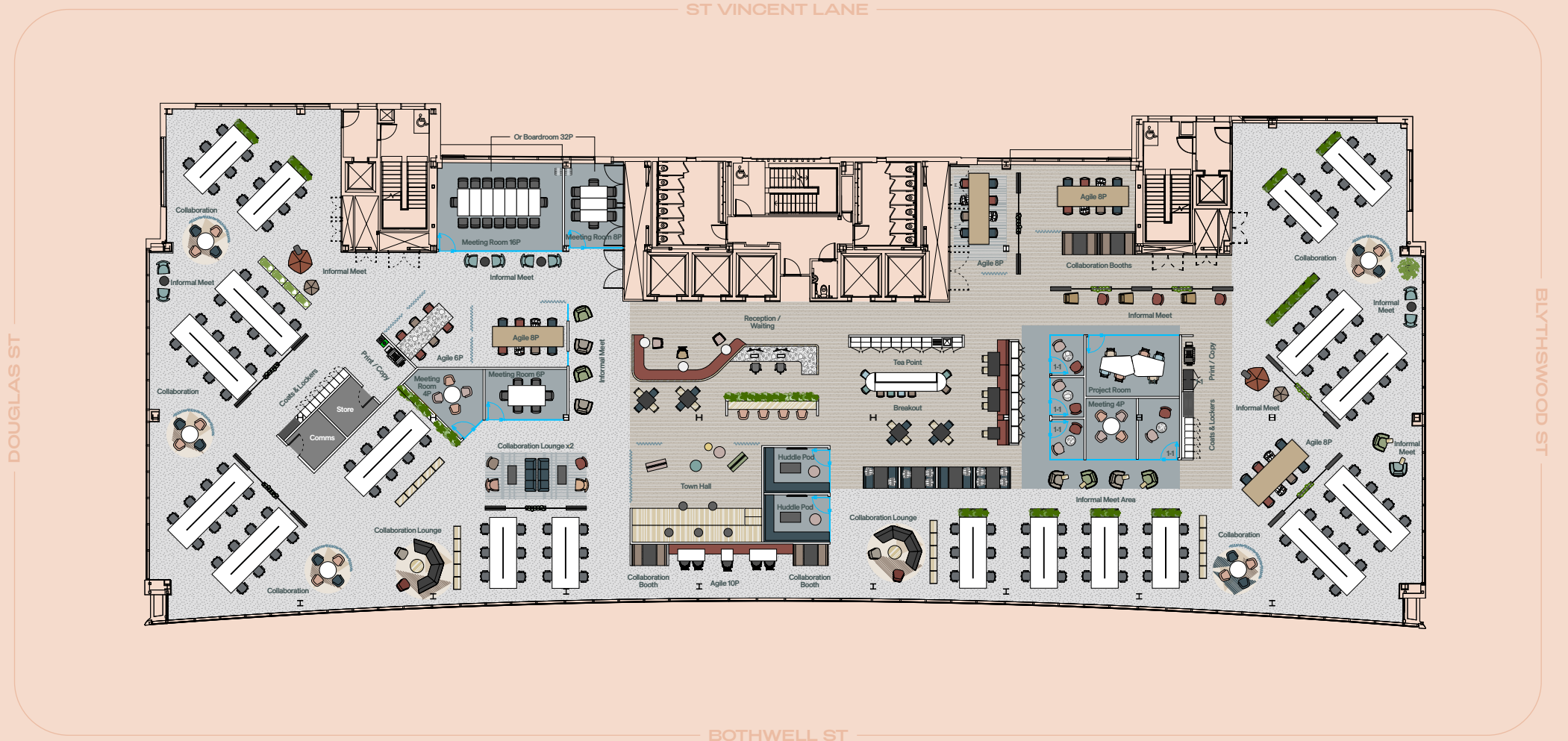

AURORA

120 Bothwell Street, Glasgow

For further information please contact:

CBRE

Sarah Hagen
sarah.hagen@cbre.com
07468 724 253

Martin Speirs
martin.speirs@cbre.com
07590 864 816



Stephen Lewis
slewis@hfdgroup.com
07500 989 524

Elliot Cumming
ecumming@hfdgroup.com
07927 586 413

MC²

Colin Mackenzie
colin@mc2-offices.com
+44 (0)7912 805 890

Andy Cunningham
andy@mc2-offices.com
+44 (0)7793 808 490

DEVELOPMENT BY

FORM/A

forma-fund.com

DEVELOPMENT
MANAGEMENT BY



hfdgroup.com